

Engine immobiliser

PRINCIPLE OF OPERATION

The engine immobilisation system is a theft protection feature which prevents the engine from being started with an incorrectly coded key.

CODED KEYS

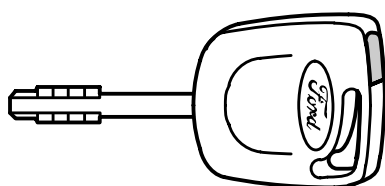

E66506

Your vehicle is supplied with coded keys.

WARNING



If a key is lost, it is imperative to erase and recode the remaining keys. Consult your dealer if you now have only one valid key.

Replacement keys must be recoded together with your other keys.

In case of loss, replacement keys are available from dealers by stating the key number shown on the tag provided with the original keys.

Note: To ensure a trouble-free data exchange between the vehicle and key, do not shield the keys with any metal objects.

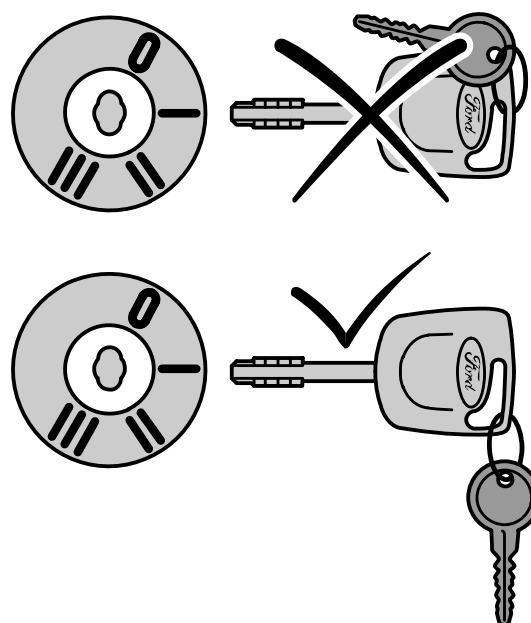

E66505

Key coding

A maximum of eight keys (including the ones supplied with the vehicle) can be coded using two other keys previously coded for your vehicle.

Complete each of the following steps **within five seconds**.

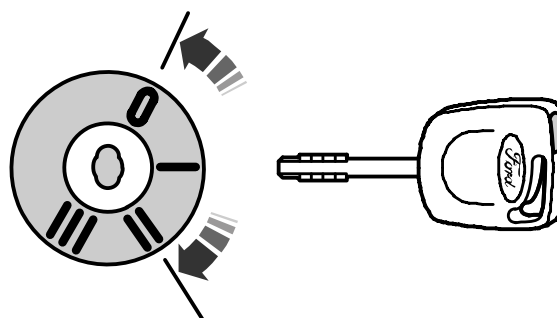

E66507

1. Insert the first key in the ignition switch and turn to position **II**.
2. Turn the key back to position **0** and remove from the ignition switch.

Engine immobiliser

3. Insert the second key in the ignition switch and turn to position **II**.
4. Turn the second key back to position **0** and remove from the ignition switch – the key coding mode is now activated.
5. If an uncoded key is now inserted in the ignition switch and turned to position **II** within 10 seconds, this key is coded to the system.
6. After the coding process is completed, remove the key from the ignition switch. Wait five seconds for the system to be activated.

If coding is not completed correctly, the indicator light flashes after the ignition is switched on with the newly coded key and the engine will not start.

Repeat the coding process after waiting 20 seconds with the ignition switched on (position **II**).

Coding erasure

With two keys coded for your vehicle you can make all the other coded keys unusable, e.g. after loss:

Complete each of the following steps **within five seconds**.

Carry out the first four steps under **Key coding**, then continue as follows:

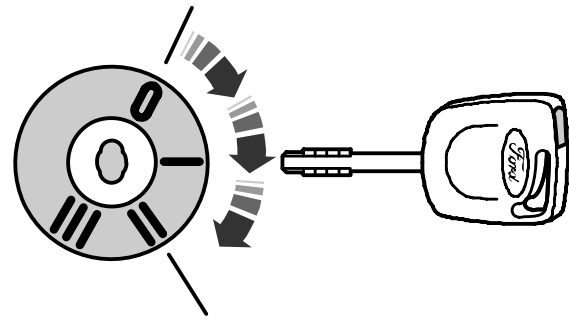

E66508

- Insert the second key in the ignition switch and turn to position **II**.
- Remove the key from the ignition switch.
- Insert the first key in the ignition switch, turn to position **II** and hold. The control light flashes for five seconds.
- If the ignition is switched off during these five seconds, the erasure process is terminated and **no** key is erased.
- If the erasure process is completed, all the other keys, apart from the two used for erasure, can no longer be used unless recoded.

Additional keys can now be coded.